

ACCENT: Liberator Support

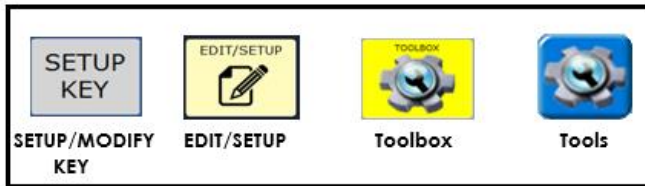

Click [HERE](#) to download NuVoice PASS

Technical Support:
01733 370 470 (Option 2)
Email: info@liberator.co.uk

Regional AAC Consultants:
If you wish to speak to your Regional AAC Consultant, please call 01733 370 470 (Option 3)

Our Liberator Support module allows staff at Liberator to remotely connect to your device using an ID and PASSWORD. This file can be placed on your desktop and linked to a button in your vocabulary. This quick reference guide will talk you through that process. Please note this will only work if you are connected to Wi-Fi.



Click [HERE](#) to download Liberator Support

Once you have downloaded this file place the file on your desktop.

1. How to start a Liberator Support Session

Select the **TOOLS** button
Select **WIN/easyChat** or **Hide/Show NuVoice**
You should now see the Windows Desktop
Double tap on the Liberator Support Icon and wait 5 -10 seconds for Liberator Support to start.

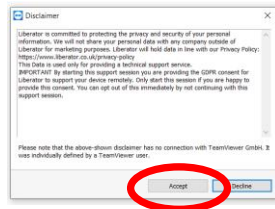

Click **ACCEPT** to start Liberator Support

Now you should see Liberator Support displayed on-screen. The person who is supporting you will need to know: Your ID and Your PASSWORD



2. Creating a link that starts Liberator Support from your vocabulary.

This instruction assumes you're adding it to the left off-screen buttons. To do this you must have the Liberator

Support on your desktop. It may be in your downloads folder, if so copy and paste it to your desktop.

Select the **TOOLS**
Select **TOOLBOX**
Select **VOCABULARY OPTIONS**
Select **CHANGE OFF-SCREEN BUTTONS**
Choose a button to use (I have selected the one highlighted in the red box which typically has right mouse click and isn't required)

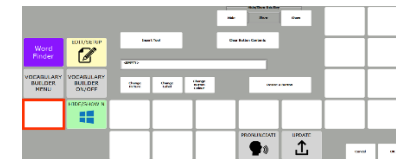

Press **CLEAR BUTTON CONTENTS**
Press **INSERT TOOL**
Select **INSERT TOOL**
Select **SPELL TOOL TO FIND**
Type **RUN**
Press **OK**
Select **RUN PROGRAM**
Select **CHOOSE ANOTHER FOLDER**
Select **USERS – ACCENT – DESKTOP**
Select **"Liberator Support.exe"**
Select **INSERT TOOL**
Select **SPELL TOOL TO FIND**
Type **HIDE** and **OK**
Select **HIDE/SHOW NUVOICE**
Select **OK**
Select **CHANGE PICTURE**
Select **SPELL ICON TO FIND**
Type the name of the picture you want
Select **OK**
Choose a picture
Select **CHANGE LABEL**
Type the name for the button label
Select **OK**
When finished, select **OK** to finish.